

CONSTRUCTION PROCESS



1



2



3



4



5



6

DIAGRAMS



DYNAMICS

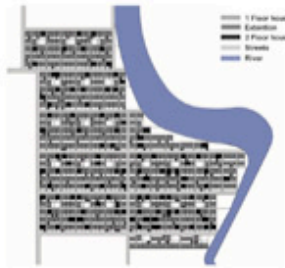

HOUSING



URBAN AGRICULTURE

SLIDE BLOCKS

Rules of the game

- 1st rule: People never move out
- 2nd rule: Each family stay on the ground
- 3rd rule: Each family have their own yard
- 4th rule: Each block of 22 houses have a plaza for common water supply
- 5th rule: One coconut tree per housing

Guy Villemore, Jingfeng Cai, Lella Farah, Ran Li



PERSPECTIVE A



PERSPECTIVE B

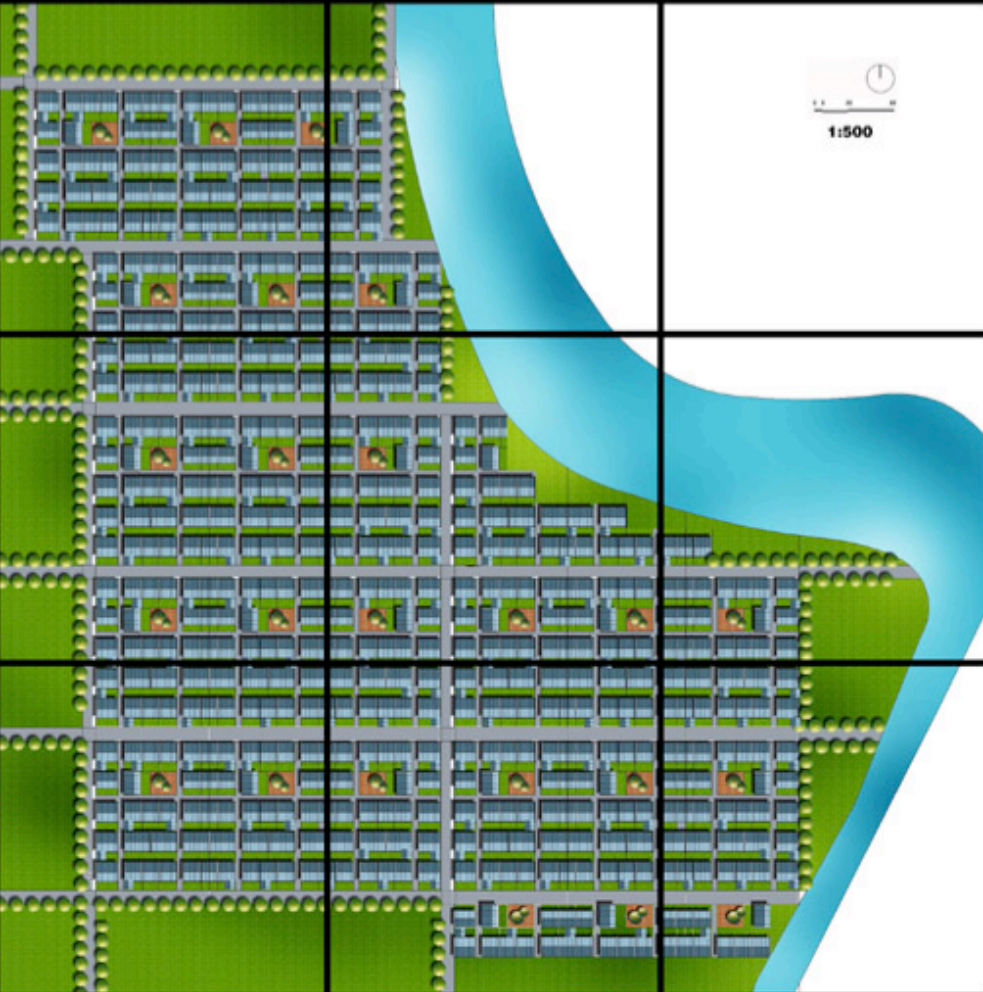

1:500

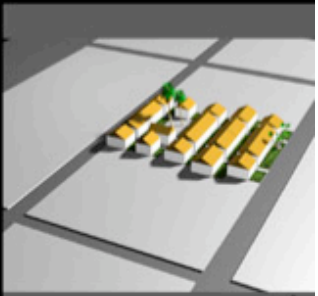

1

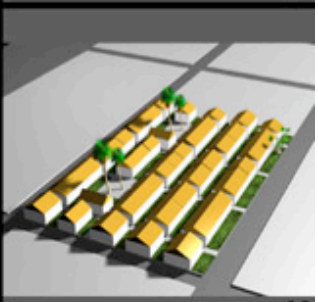

1'

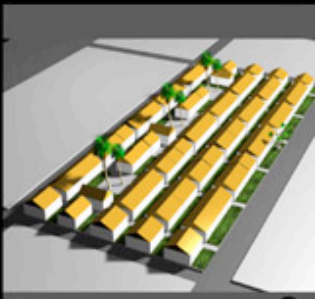

2