

**Part 1 General****1.1 Summary**

- .1 Unless otherwise indicated, follow the standards below when specifying toilet partitions. These standards are not intended to restrict or replace professional judgment.

**1.2 Design Requirements**

- .1 All partitions shall be vandal resistant, graffiti resistant, scratch resistant, and impact resistant.
- .2 All stalls shall have built-in gap-free interlocking at the doors. Polypropylene or other “brush” type gap fillers are not acceptable.
- .3 All stalls that are part of a renovation where the existing partitions are kept must be retrofitted to ensure privacy.
- .4 Gendered washrooms stalls:
  - .1 New stall partitions shall be ceiling hung unless physical limitations prevent this type of installation.
  - .2 Stall partitions and doors shall be installed 100 mm (4”) from the finished floor. For accessible stalls, the front partition, the door, and at least one side partition shall provide a toe clearance of at least 230 mm (9”) above the floor. If the depth of the accessible stall is greater than 1525 mm (60”), then the toe clearance is not required, and its partitions and doors shall be 100 mm (4”) from the finished floor.
- .5 Gender inclusive washrooms stalls:
  - .1 Stall partitions could be made with gypsum assemblies or with floor-mounted toilet partitions.
  - .2 Stall partitions shall be floor to ceiling height.
  - .3 Doors shall leave a bottom gap of 100mm (4”) from the finished floor. The height of the top gap above the door shall be assessed with ventilation and sprinkler requirements while still ensuring privacy.
  - .4 For accessible stalls, the front partition, the door, and at least one side partition shall provide a toe clearance of 230 mm (9”) above the floor. If the depth of the accessible stall is greater than 1525 mm (60”), then the toe clearance is not required, and its partitions shall be floor to ceiling height.

**1.3 Guarantee**

- .1 All work described in this section shall be guaranteed for a period of five (5) years from the date of substantial completion of the work.

**Part 2 Products****2.1 All Partitions**

- .1 Shall be phenolic, Prestige series as manufactured by Decolam or Solid Core Reinforced Composite same color throughout, SierraSeries 1090, as manufactured by Bobrick or approved equivalent.
- .2 Stainless steel partitions are not acceptable.

**2.2 Urinal Partitions**

- .1 Shall be wall flange-mounted screen, unless noted otherwise.

**2.3 Hardware**

- .1 All hardware is to be 18-8 or type 304, stainless steel with satin finish.
- .2 A safety release system shall be provided for access from the exterior in case of emergency.
- .3 Specify occupancy indicators.

**2.4 Retrofit**

- .1 Partition panel extensions to bridge a floor to partition gap that is currently greater than the required clearance:
  - .1 Anodized aluminum H bracket, partition panels to match the existing (color, material) of the height required to bridge the gap, flanges on both sides of the new panel (match existing where possible), appropriate mechanical fasteners.
- .2 Privacy trim (to cover door and stile gaps):
  - .1 25 mm (1") Stainless steel 10-gauge plate covering the full length of the gap, mechanically fastened to the partitions, as manufactured by Decolam or approved equivalent.

**2.5 Structural System**

- .1 Washroom partitions hung from the ceiling shall have a structural support designed by a structural engineer. A sealed structural engineer shop drawing shall be submitted for the suspension to the slab (or other structure above).
- .2 Suggested mounting systems for ceiling-hung partition:

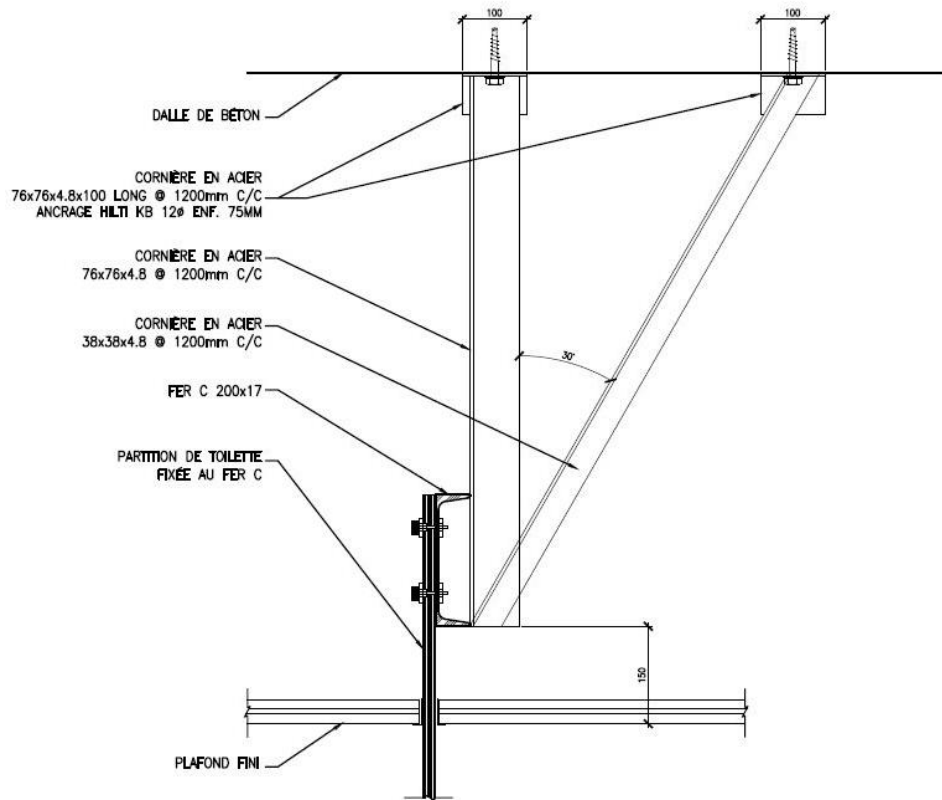

### Part 3 Related Technical Sections

The technical sections of the McGill Building Design and Technical Standards should be consulted with the current document, most notably (but not limited to) the following:

Section Number	Title of Section
Special Building Areas	Washrooms
06 10 00	Rough Carpentry
09 21 26	Gypsum Board Assemblies
09 22 27	Suspended Ceiling
09 30 13	Ceramic Tiling
09 91 26	Painting
10 21 20	Toilet and Bath Accessories

**END OF SECTION**